

**Hammersmith and Fulham  
Proposed Submission Local Plan  
Proposals Map Changes**

**July 2016**

## Explanatory Note

The changes listed below include proposed additions, deletions and amendments to the existing Core Strategy 2011 Proposals Map. The major changes result from the establishment of the Old Oak and Park Royal Development Corporation (OPDC) in April 2015 and the consequent transfer of the responsibility for planning this area from Hammersmith and Fulham Council to the OPDC. All other designations on the Local Development Framework Proposals Map that are not included in this schedule remain unchanged. For reference, there are no entries in the schedule for AM11 or AM22.

**Table 1: Designations to be ADDED**

<b>Designation</b>	<b>Proposed additions</b>	<b>Reason for the changes</b>	<b>Map Ref</b>
<b>Old Oak and Park Royal Development Corporation</b>	Boundary for that part of the Old Oak and Park Royal Development Corporation extending into Hammersmith and Fulham.	To identify OPDC which came into effect in April 2015.	AD1
<b>Strategic Site policies</b>	Hammersmith Flyover, A4 and adjoining land (HRA3) - to include A4 land running from Colet Gardens in the east to the Cromwell avenue underpass in the west. Includes the Hammersmith Gyratory, the Broadway Centre, the area south of Black's Road to Hammersmith Bridge Road, the British Transport Police Station and adjacent land to the east on Talgarth Road, the Ark and West London Magistrates Court.	To identify new strategic site in Hammersmith Regeneration Area	AD2
	Imperial Gasworks National Grid (SFRRRA1) to include land owned by National Grid.	To include new site in the South Fulham Riverside Regeneration Area.	AD3
<b>HS2 -extent of safeguarding</b>	New HS2 safeguarding area on strip of land over St Mary's RC Cemetery (Please note that the major safeguarded area is now within the OPDC)	To show extent of new safeguarding direction.	AD4
<b>Retail designations</b>	New Neighbourhood Parade: Parsons Green Lane (47 Parson's Green Lane, 51 Parson's Green Lane, 61 to 77 Parson's Green Lane, 1-3 Parson's Green, Dexter Court and Brigade House at Parson's Green Lane.	To reflect proposed new designation.	AD5

**Table 2: Designations to be DELETED**

<b>Designation</b>	<b>Proposed deletions</b>	<b>Reason for the changes</b>	<b>Map Ref</b>
<b>All designations now within the Old oak and Park Royal Development Corporation (OPDC)</b>	Remove Park Royal Opportunity Area; Strategic Site PR1 – Old Oak Common Sidings; Strategic Site PR2 – North Pole Road; Employment Zone/Strategic Industrial Land (SIL); Longer Distance Canal Walk; Nature Conservation Areas M6, B1.1, B1.2 and B1.7 (part); Aerodrome Safeguarding – Northolt (part); Waste Sites; Crossrail 1 – extent of safeguarding (part); Green Corridor – Euston to Watford DC Line; London Distributor Road (part) Wormwood Scrubs [OS1] (part); Wormwood Scrubs Metropolitan Open Land (part) Aerodrome Safeguarding – Heathrow (part).	The OPDC launched on 1 April 2015 is now the planning authority for this part of LBHF.	N/A
<b>Strategic Site policies</b>	Strategic Site FRA2- North End Road/ Lillie Road/ Chuter Ede House/ Coomer Place car park strategic site and regeneration area.	No longer identified as a strategic site.	N/A
	HTC3- Hammersmith Embankment strategic site and estate regeneration area (Queens Wharf and Riverside Studios; Queen Caroline Estate river frontage; and Hammersmith Embankment former office site).	Hammersmith Embankment development is underway; estate regeneration is no longer part of Council's Housing Strategy; and other parts of site can be progressed without the need for a site policy.	N/A
	HTC2 – Kings Mall and Ashcroft Square Estate, King Street strategic site and estate regeneration area	No longer identified as a strategic site.	N/A
<b>Housing Estate Regeneration Areas</b>	Remove existing designations within Fulham Regeneration Area, White City Regeneration Area and Hammersmith Regeneration Area.	Estate regeneration no	N/A

Designation	Proposed deletions	Reason for the changes	Map Ref
		longer part of council's Housing Strategy.	

**Table 3: Designations to be AMENDED**

<b>Designation</b>	<b>Proposed amendments</b>	<b>Reason for the change</b>	<b>Map Ref</b>
<b>Regeneration Areas</b>	Hammersmith Regeneration Area: Rename title of Inset Map and amend boundary to include A4 south of Hammersmith Friends Meeting House and land south of Down Place; include A4 up to Royal Ballet School; and remove Queen Caroline Estate, Riverside Studios and Queens Wharf as well as the area including Hammersmith Embankment and remove properties at 1-48 Cromwell Avenue (Pocklington Estate) and 209-215 King Street.	New name. Boundary changes to allow for inclusion of a policy for the Flyover strategic site and affected adjacent land. Areas to be deleted can be adequately considered under borough-wide development management policies.	AM6
	White City Regeneration Area: rename title of Inset Map.	New name.	N/A
<b>Strategic Site Policies</b>	Rename existing site WCOA1 to read WCRA1. Include BBC One and BBC Media Village within boundary, as well as Shepherd's Bush Bus Station and the DIMCO building north of Westfield London.	To acknowledge that these sites are also expected to come forward for development within the Plan period.	AM7
	Rename existing WCOA2 to read WCRA2 and redraw boundary to combine existing 5 parts of former WCOA2.	To improve legibility.	AM8
	Rename WCOA3 to read WCRA3.	To reflect new referencing	N/A

<b>Designation</b>	<b>Proposed amendments</b>	<b>Reason for the change</b>	<b>Map Ref</b>
	Amend boundary of FRA1 to include previous three separate parts of FRA1 as well as the area covering Empress Place, Langtry Place and Rickett Street; the pub on corner of West Cromwell Road and North End Road; and ad hoc strips of railway and highways land	To improve legibility and link up the separate parcels of land.	AM9
	Rename HTC1 to read HRA1 and amend boundary to remove Thomas Pocklington Trust Properties at 1-48 Cromwell Avenue and 209-217 King Street.	To reflect revised site boundaries.	AM10
<b>Thames path</b>	<p>Delete section of “Thames Path National Trail- PROPOSED” that runs between River Terrace and the river.</p> <p>Delete section of “Thames Path National Trail TEMPORARY” that diverts along Chancellors Road and through the Hammersmith Embankment (Fulham Reach) site.</p> <p>Add a new section of “Thames Path National Trail- PROPOSED” along front of Queen’s Wharf.</p> <p>Add a new section of “Thames Path National Trail – EXISTING” along front of Hammersmith Embankment (Fulham Reach) site.</p>	<p>To reflect proposal for new section along Queens Wharf</p> <p>To reflect completion of new section (see below)</p> <p>To reflect proposed new section.</p> <p>To reflect completion of new section of the Thames Path</p>	AM12
<b>Open Space and nature conservation areas</b>	Amend boundary of Parsons Green Club [OS43] to remove area of land fronting Sullivan Road that has been developed to provide 7 new houses.	To reflect loss of open space to new housing development.	AM13

Designation	Proposed amendments	Reason for the change	Map Ref
	Amend boundary of St Paul's Open Space [OS27] to exclude part of open space now within boundary of hotel at 153 Hammersmith Road and add land at St Mary's churchyard. Also, as a consequence, amend nature conservation area L8.	To reflect existing position	AM14
	Amend boundary of White City Community Garden [OS30] to reflect reduced size of garden resulting from building area housing office. Also, as a consequence, amend nature conservation area L1. In addition, add playgrounds to the south of New Zealand Way. Site to be renamed as White City Community Garden and adjoining playgrounds	To reflect existing position.	AM15
	Amend boundary of Hammersmith Park [OS36] to remove part that is within the BBC TV site and not part of the park Also, as a consequence, amend nature conservation area B11.2.	To reflect correct position of boundary.	AM16
	Amend boundary of South Park [OS12] to include games courts at south boundary of park.	To reflect that the games court is part of the open space.	AM17
	Amend boundary of nature conservation area B1.7 opposite Wormwood Scrubs Prison to reflect situation on the ground.	To reflect correct position of boundary.	AM18
	Realign boundary of Normand Park [OS10] to reflect refurbishment of park. Also, as a consequence, amend nature conservation area L11.	To reflect correct position of boundary.	AM19
	Amend boundary to Fulham Cemetery [OS32] to exclude Fulham Lodge and depot. Also, as a consequence, amend nature conservation area L10.	To reflect disposal of Lodge and depot.	AM20

<b>Designation</b>	<b>Proposed amendments</b>	<b>Reason for the change</b>	<b>Map Ref</b>
	Amend boundary of Ravenscourt Park [OS3] to remove White Lodge rear garden. Also, as a consequence, amend nature conservation area B11.3. In addition, add tea room and adjoining land including park entrance.	to reflect fact that garden is not part of the open space. In addition, to acknowledge tea room, etc is within the park boundary.	AM21
	Amend boundary of nature conservation area B11.2 to take into account development on Waldo Road site	To reflect loss of land to new housing development	AM23
	Amend boundary of Burlington Danes school playing fields [OS37] to take into account proposed new school building	To reflect loss of land to new school development	AM24
	Amend boundary of Lillie Road recreation ground [OS8] to include neighbouring Purcell Gardens. Site to be renamed Lillie Road recreation ground and Purcell Gardens	To add adjacent open space.	AM25
	Amend Rowberry Mead [OS25] to reflect situation on the ground.	To reflect correct position of boundary	AM26
<b>Retail designations</b>	Add 124 to 128 and 157 to 165 Askew Road to Askew Road Key Local Centre.	To reflect existing retail provision.	AM27
	Add 78 to 84 North End Road and the Three Kings Pub to North End Road Key Local Centre.	To reflect existing retail provision and that the public house is within the centre.	AM28



<b>Designation</b>	<b>Proposed amendments</b>	<b>Reason for the change</b>	<b>Map Ref</b>
	Add Sainsbury's on former Janet Adegoke Centre at Bloemfontein Road neighbourhood parade.	To reflect existing retail provision.	AM29
	Add 412 to 420 Uxbridge Road West to Uxbridge Road West neighbourhood parade.	To reflect existing retail provision.	AM30
	Change name of Greyhound Road neighbourhood parade to Fulham Palace Road North and add 168 to 190, 169 to 177, 208 to 220, 193 to 207 and 209 to 211 Fulham Palace Road & 392 to 402 Lillie Road. Remove 2 to 10 and 3 to 11 Greyhound Road.	To reflect existing retail provision.	AM31
	Wandsworth Bridge Road North and South to be combined and re-designated as a Key Local Centre. Add additional commercial units on West side from 142 -198	To reflect existing retail provision.	AM32
	Add 77 to 85 Goldhawk Road at Goldhawk Road satellite parade.	To reflect existing retail provision.	AM33
	Add 68 to 80 Fulham Palace Road to Fulham Palace Road satellite parade.	To reflect existing retail provision.	AM34
<b>Town centre boundary</b>	Extend boundary of Shepherds Bush town centre boundary to include land to the north of the existing Westfield London up to the Hammersmith & City Line viaduct.	To acknowledge the development of additional retail and housing currently being built as part of the extension to the Westfield London shopping centre.	AM35

<b>Designation</b>	<b>Proposed amendments</b>	<b>Reason for the change</b>	<b>Map Ref</b>
<b>Views from Bridges</b>	View from Putney rail bridge- symbol should be shown to effect views toward the north east only.	To amend a previous error.	N/A
<b>Conservation Areas</b>	Amend boundary of Bradmore Conservation Area.	To reflect Conservation Area boundary changes	AM36

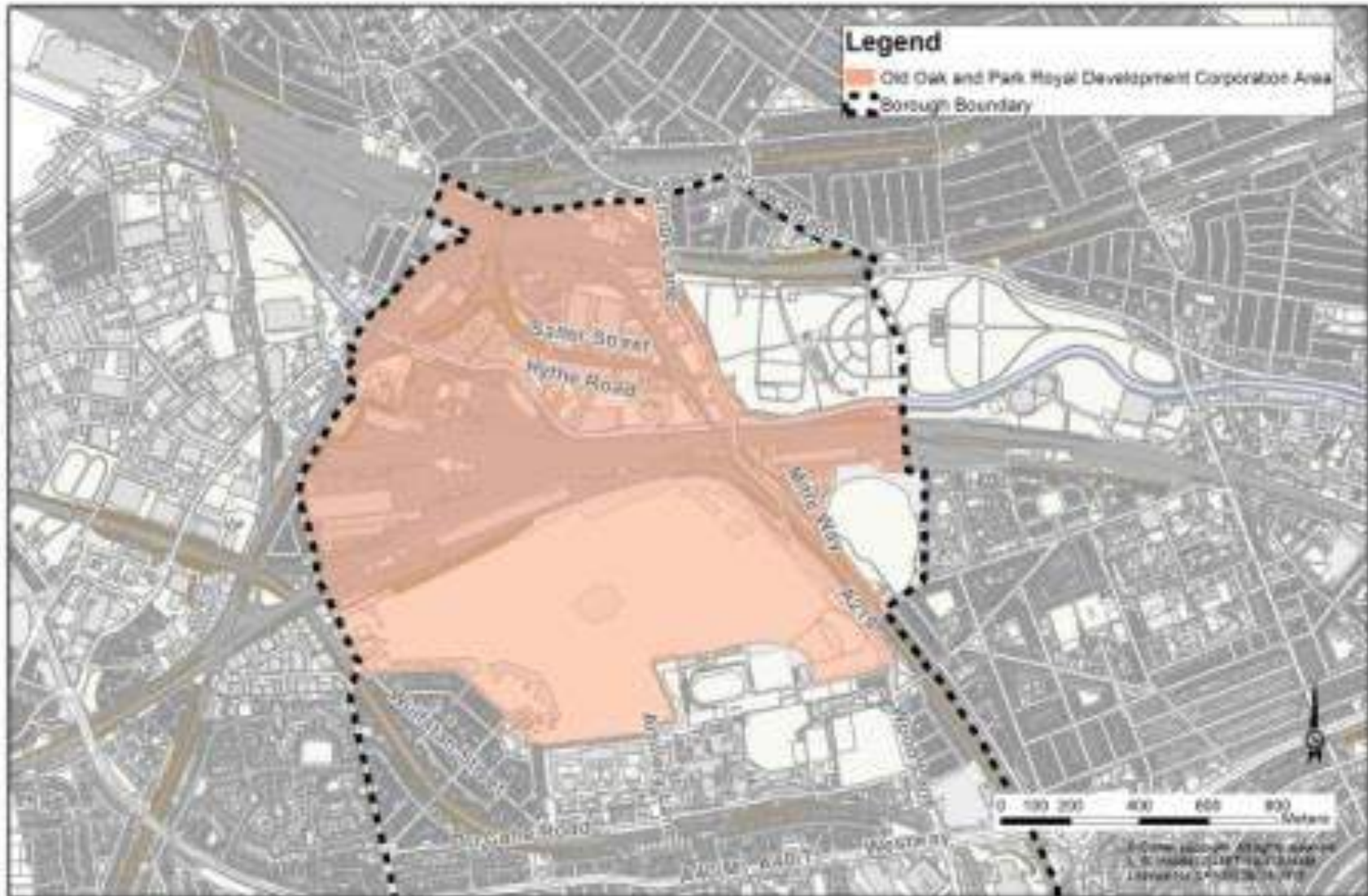

**Map AD1: Old Oak and Park Royal Development Corporation Area**

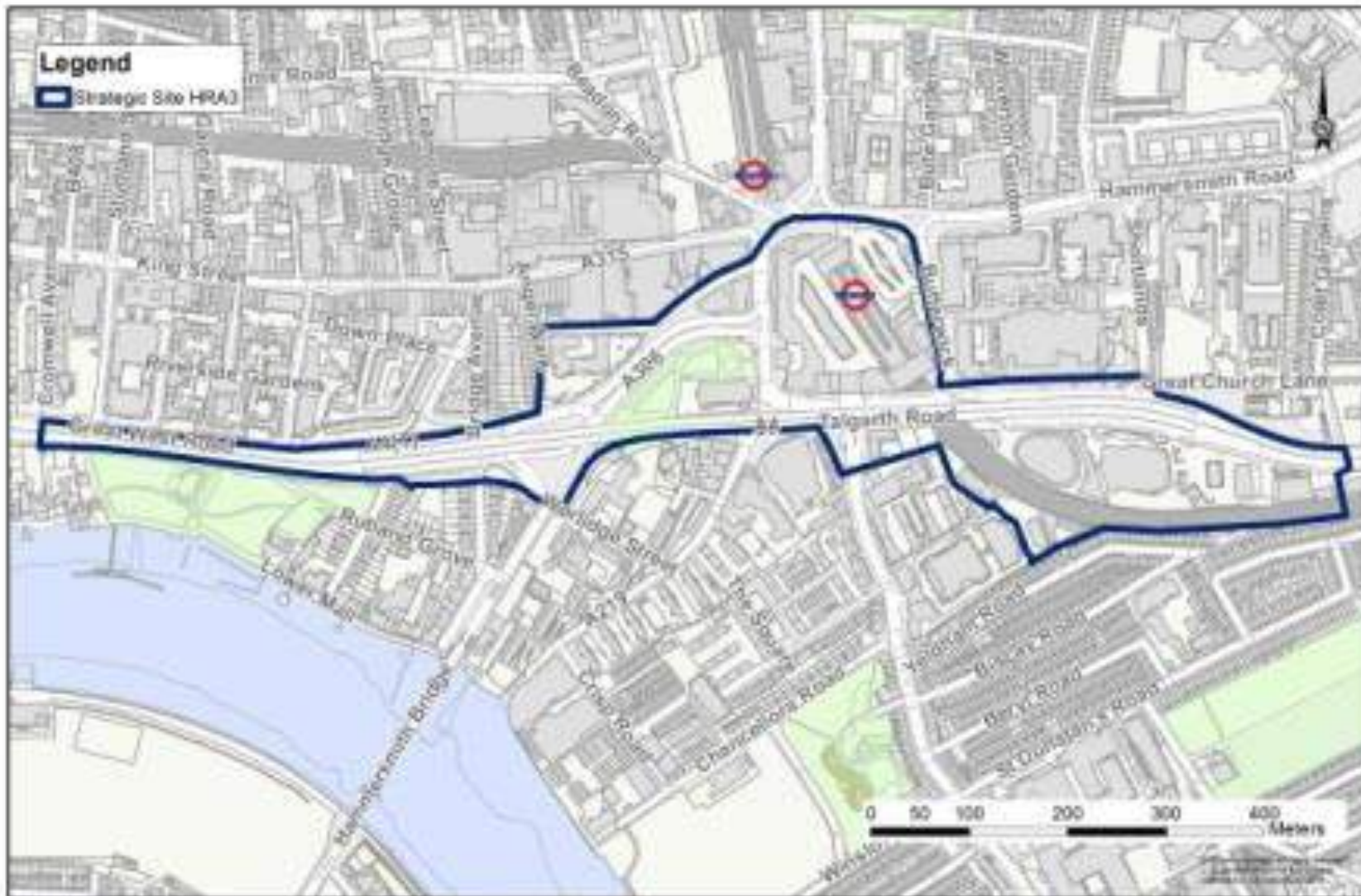

**Map AD2: Hammersmith Flyover, A4 and Adjoining Land [HRA3]**

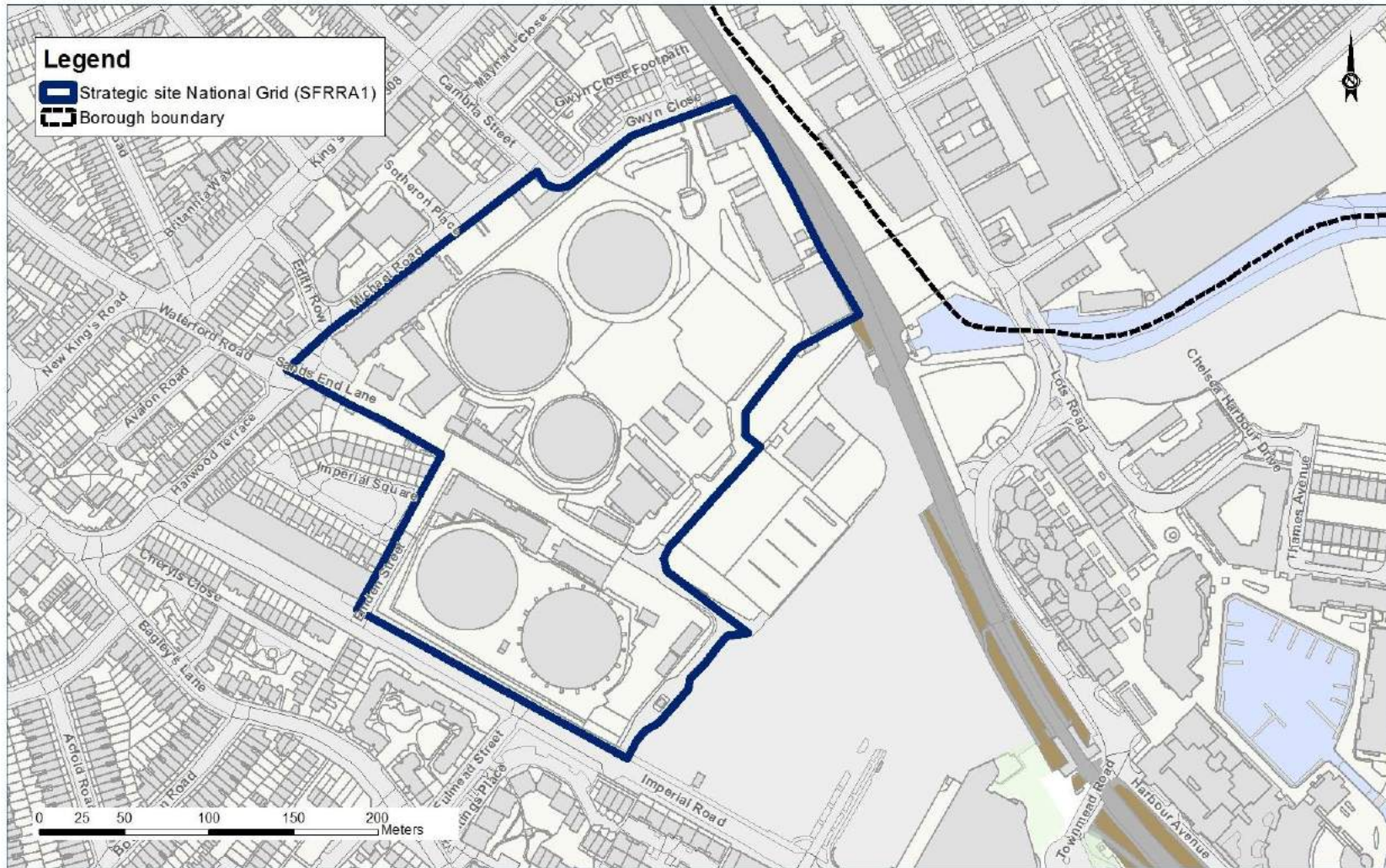

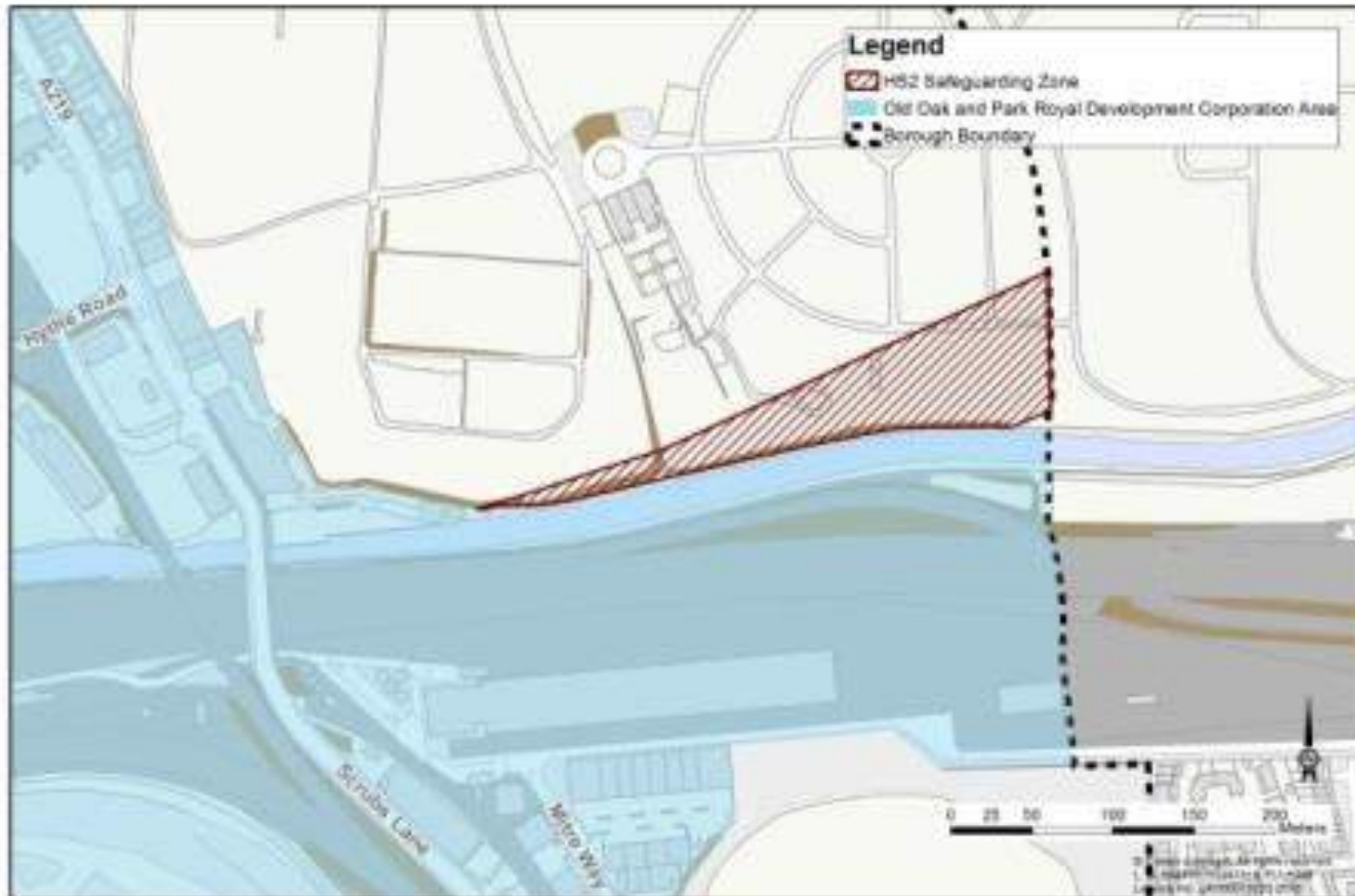

**Map AD4: HS2 - Extent of Safeguarding**

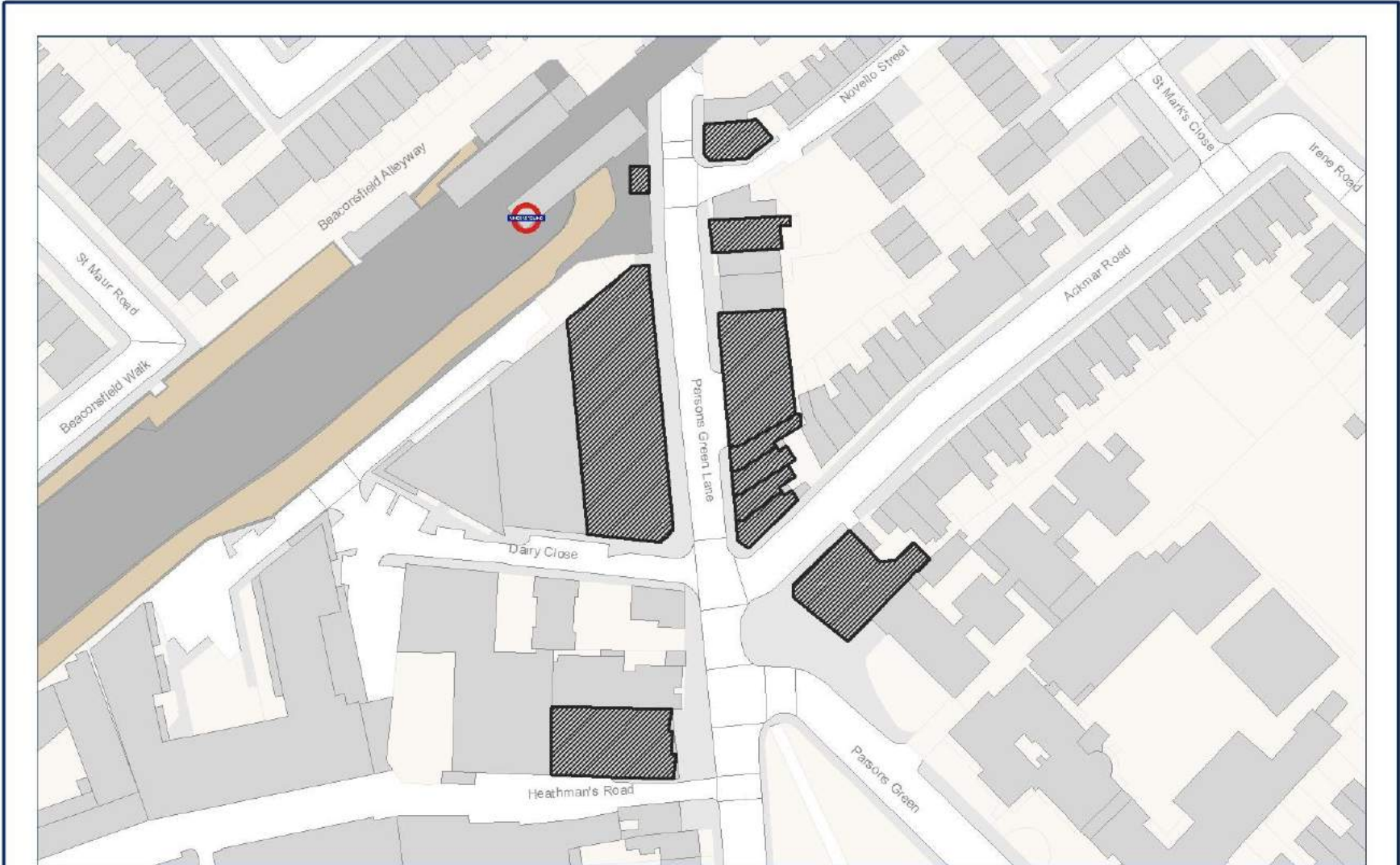

**Map AD5:  
Parsons Green Lane (Neighbourhood Parade)**

© Crown copyright and database rights  
2014 Ordnance Survey Licence No. LA10019223

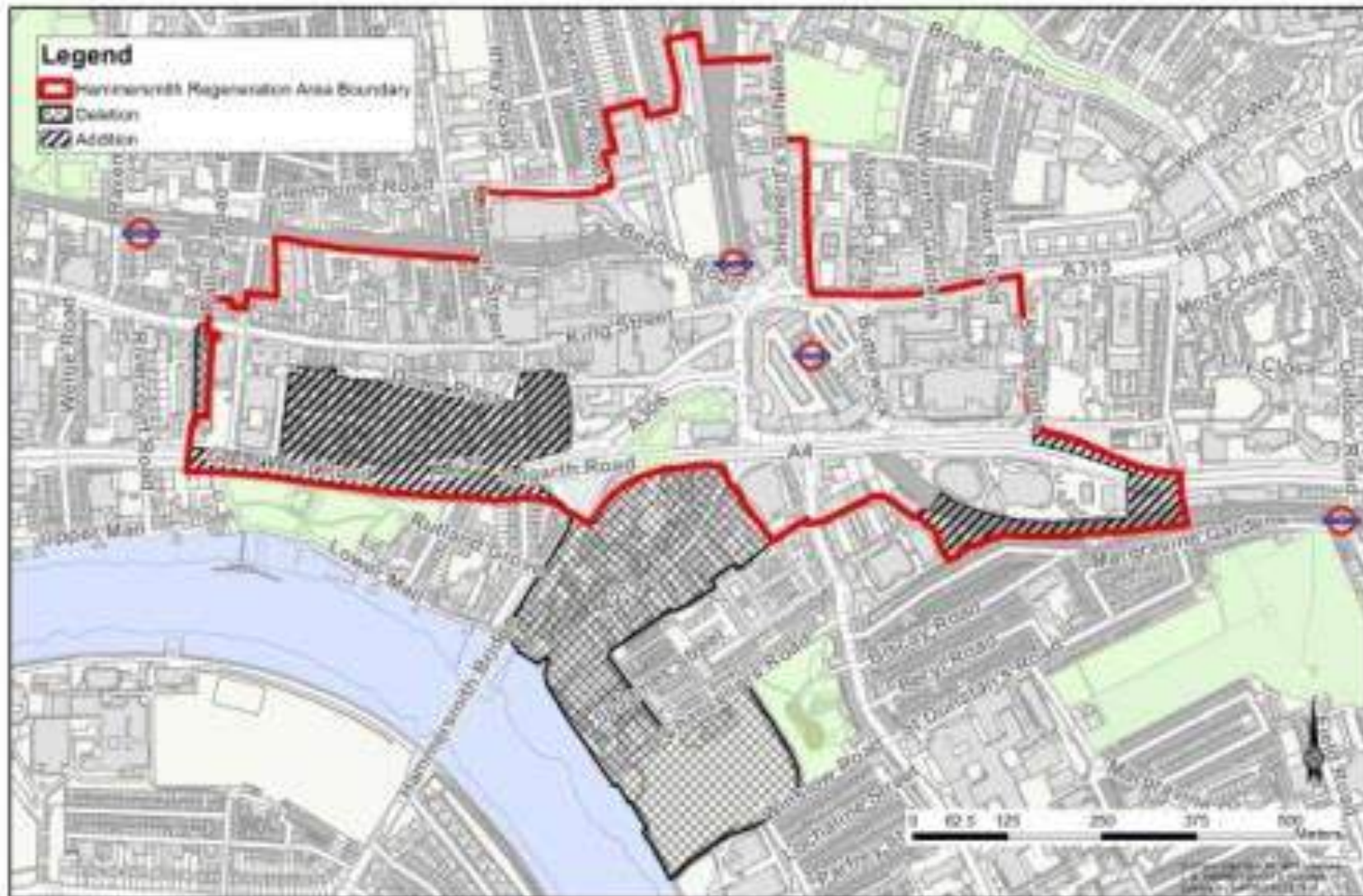

**Map AM6: Hammersmith Regeneration Area**



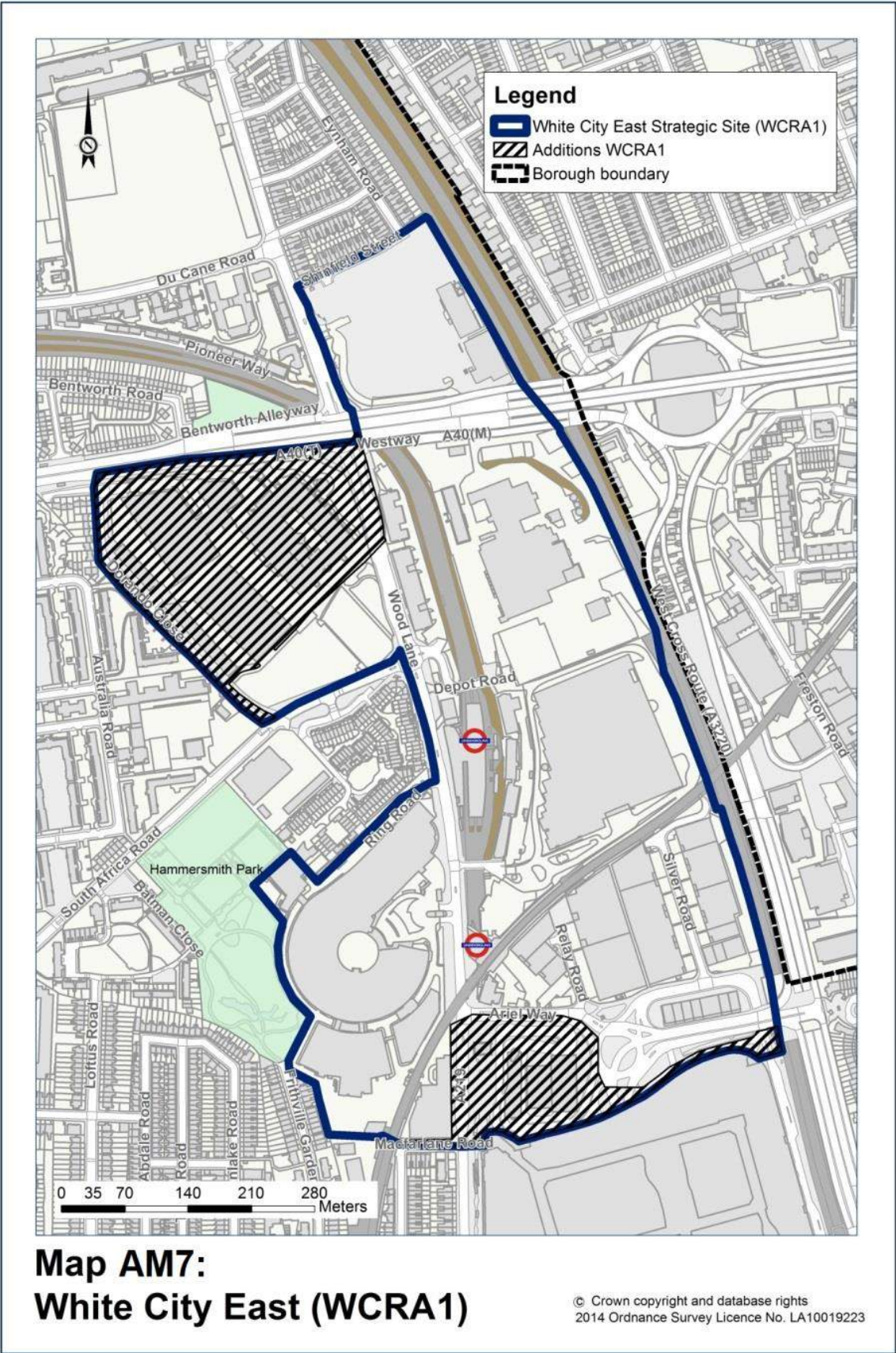



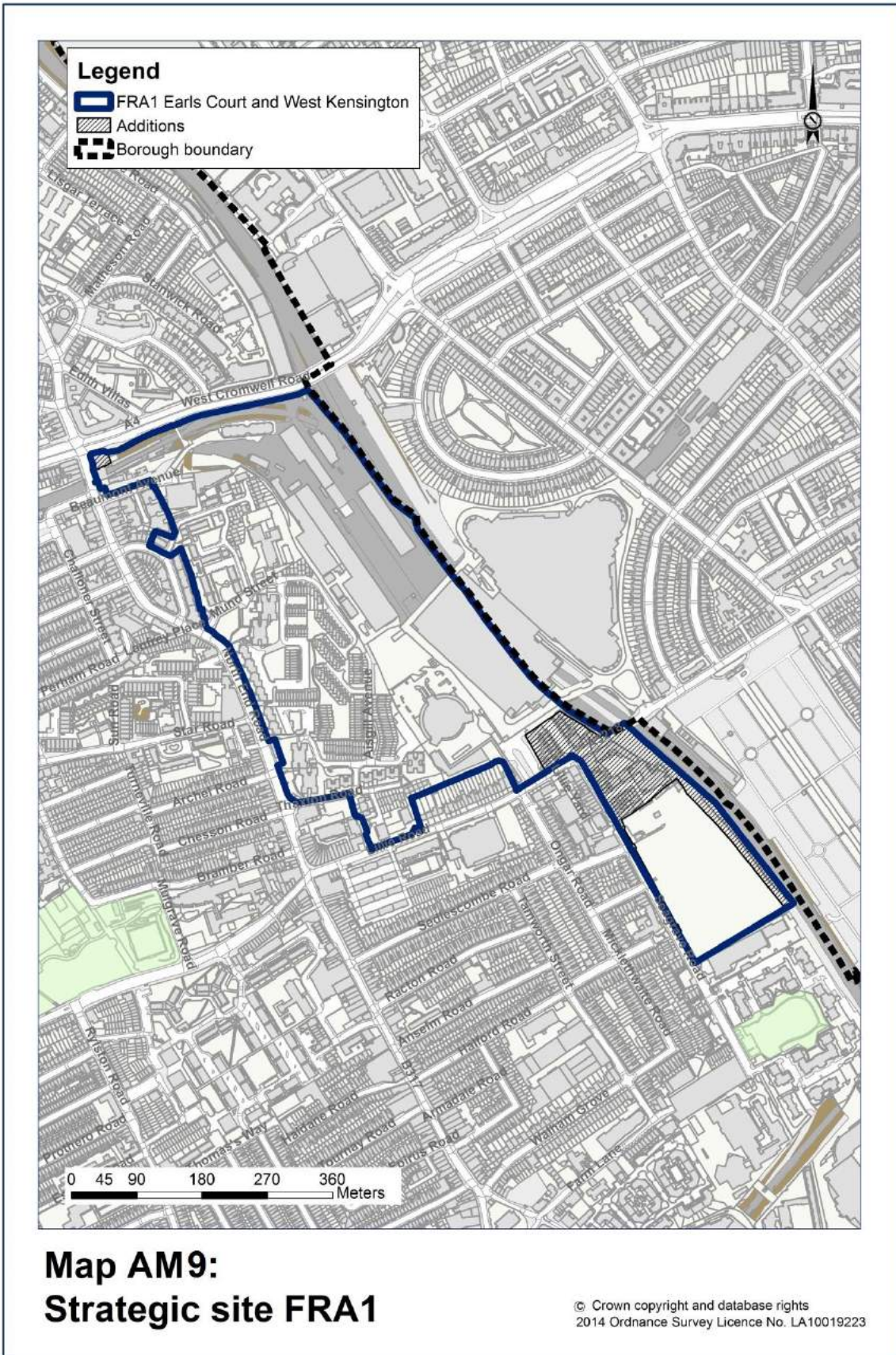



**Map AM10:  
Town Hall Extension and adjacent land, Nigel Playfair Avenue**

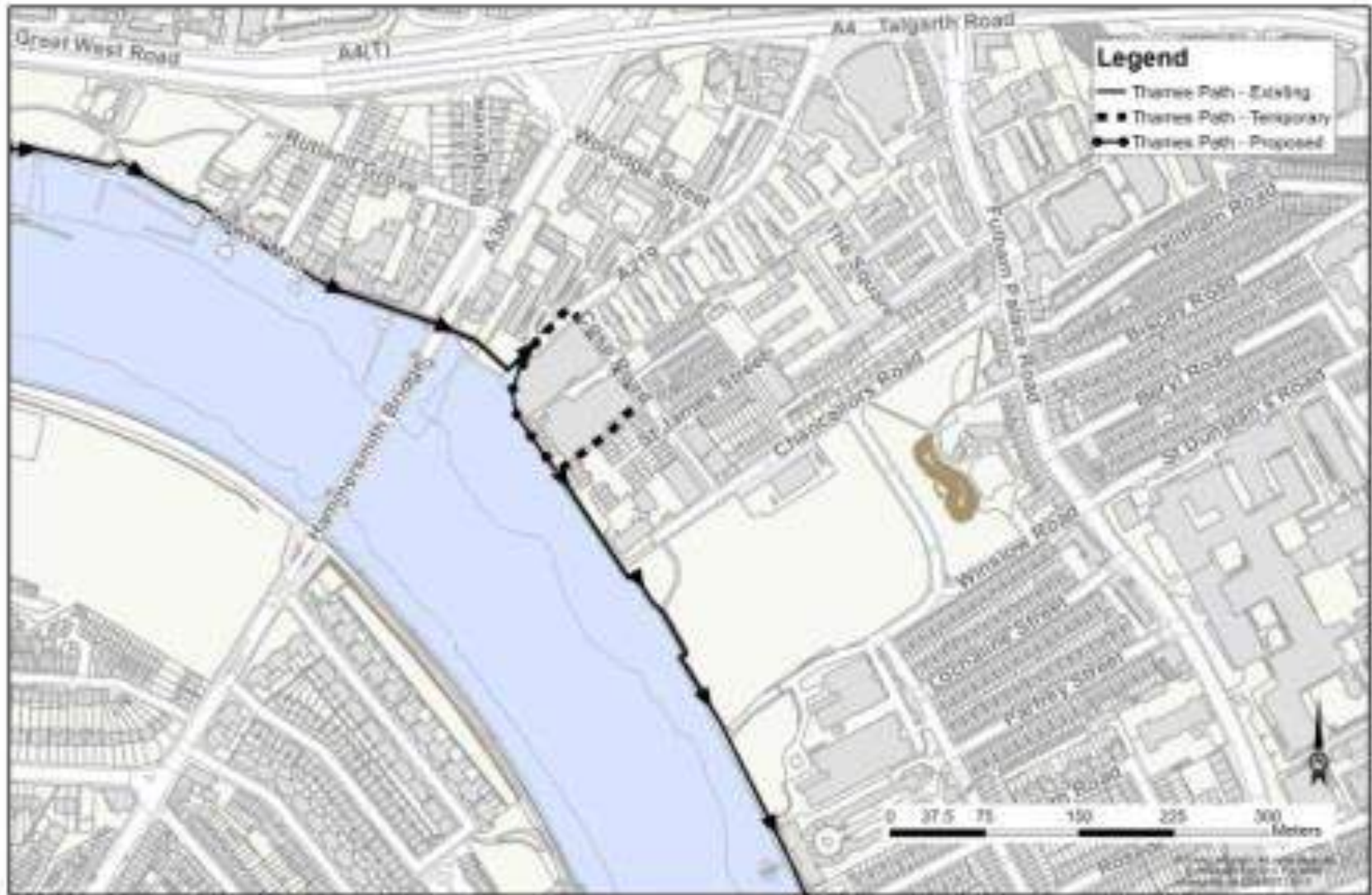

**Map AM12: Thames Path**



**Map AM13: Parsons Green Club [OS43]**



**Map AM14: St Paul's Open Space [OS27]**

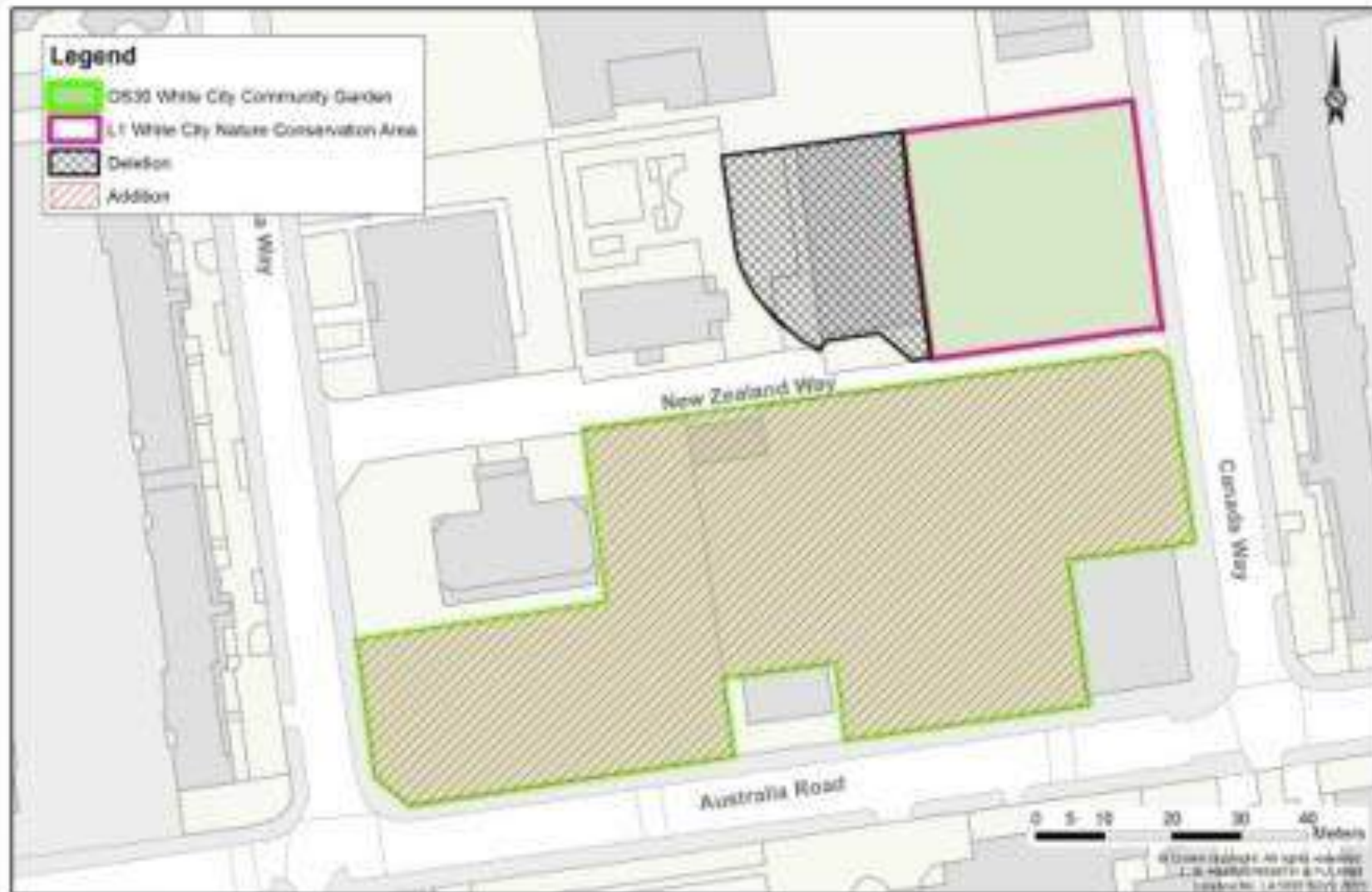

**Map AM15:  
 White City Community Garden Open Space [OS30] and Nature Conservation Area [L1]**





**Map AM16:  
Hammersmith Park (OS36)**

© Crown copyright and database rights  
2014 Ordnance Survey Licence No. LA10019223



**Map AM17: South Park [OS12]**

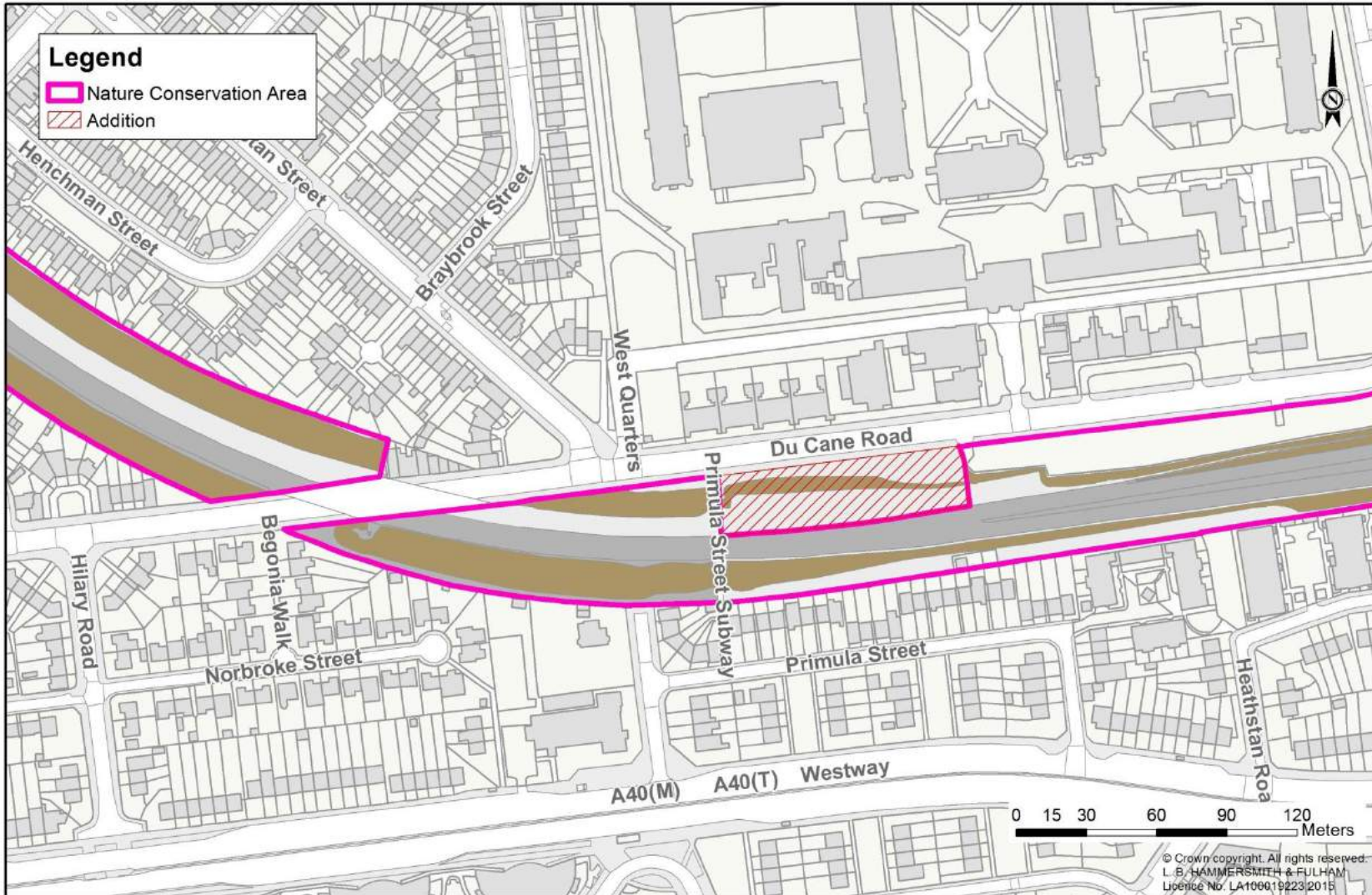

**Map AM18: Railside Habitats [B1.7] - Near Wormwood Scrubs**

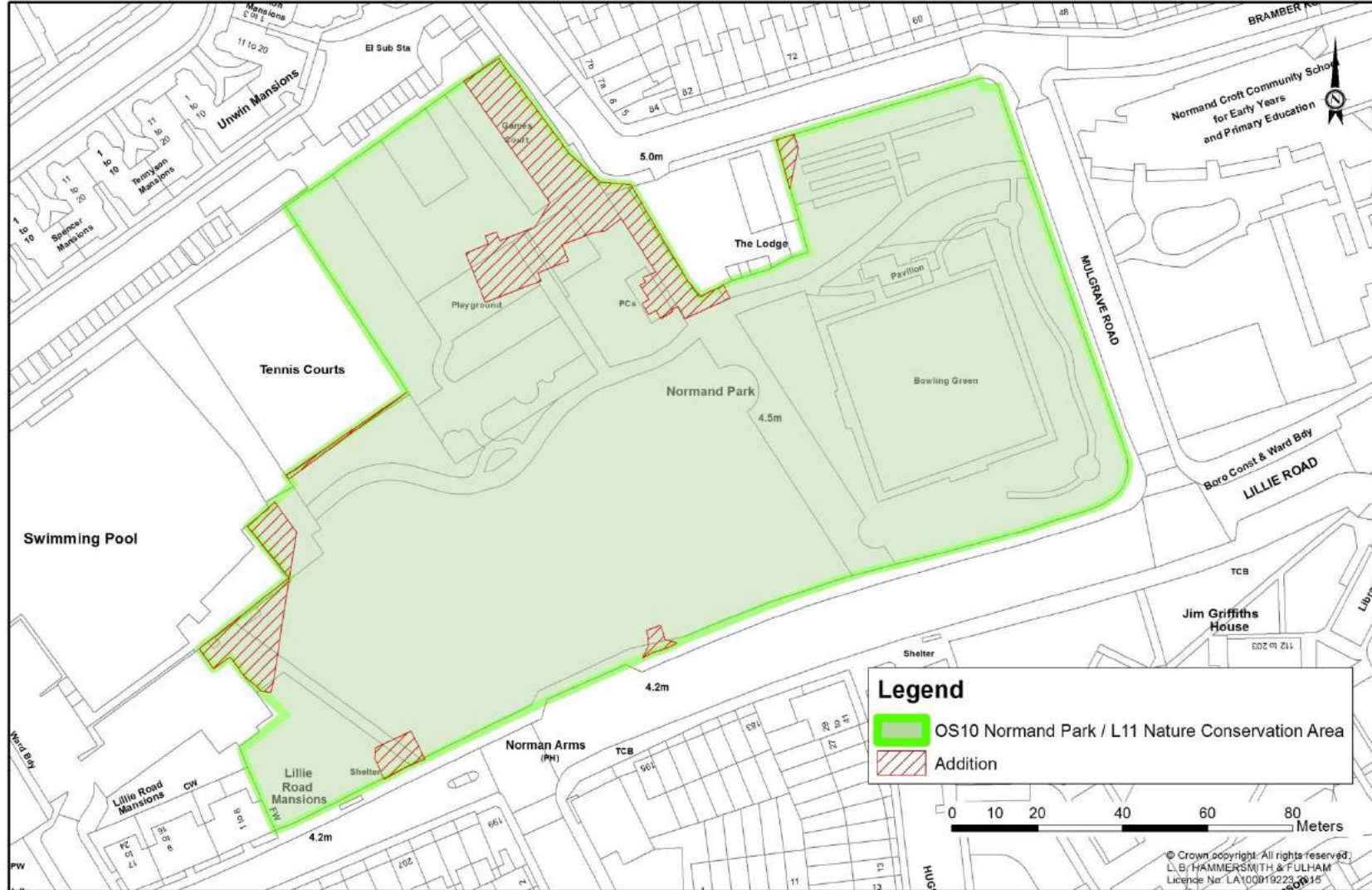

**Map AM19: Normand Park [OS10] and L11 Nature Conservation Area**



**Map AM20: Fulham Cemetery (OS32)**

© Crown copyright. All rights reserved.  
 L. B. HAMMERSMITH & FULHAM  
 Licence No. LA100019223 2015

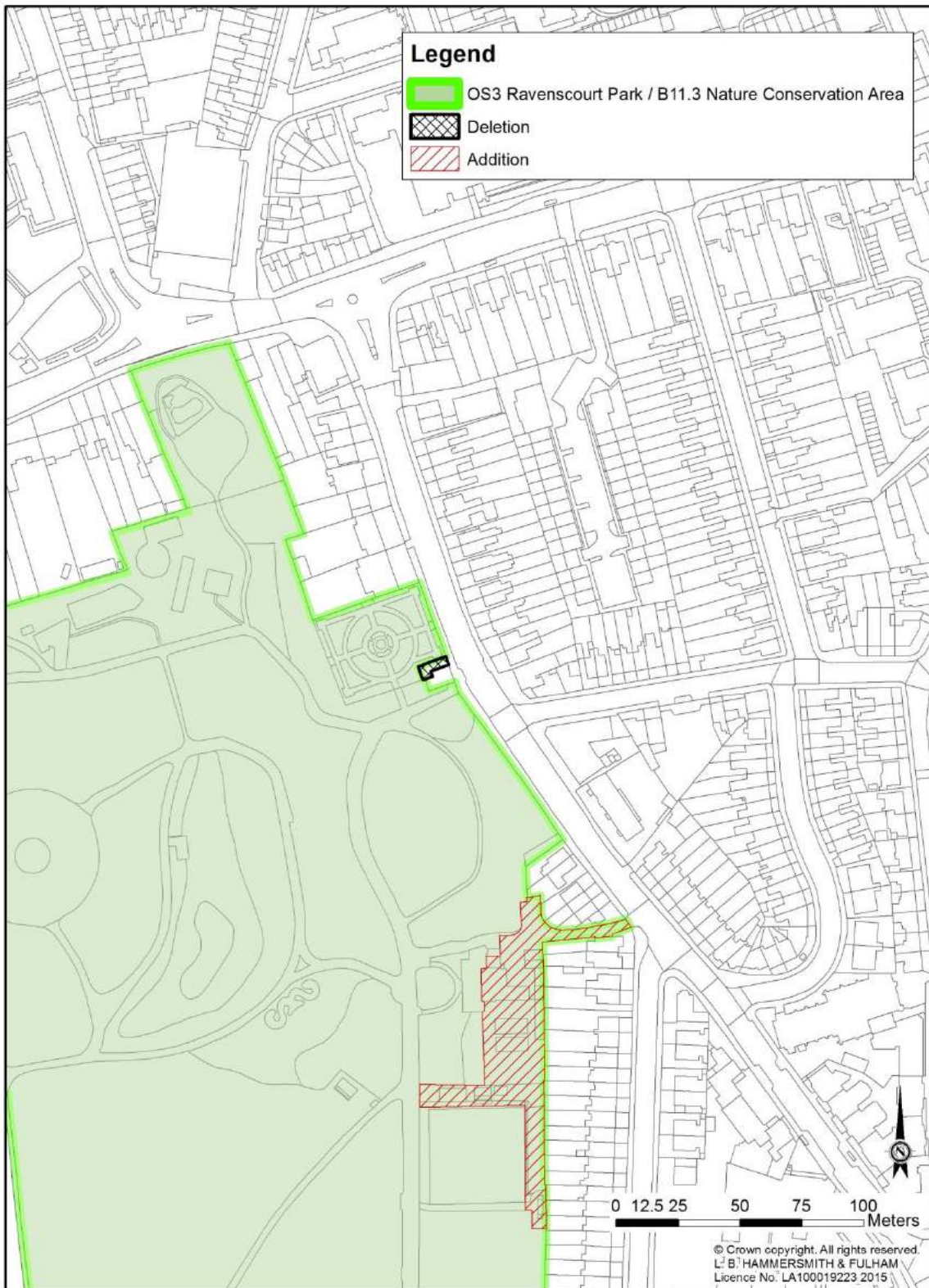

**Map AM21:  
 Ravenscourt Park [OS3] and B11.3 Nature Conservation Area**

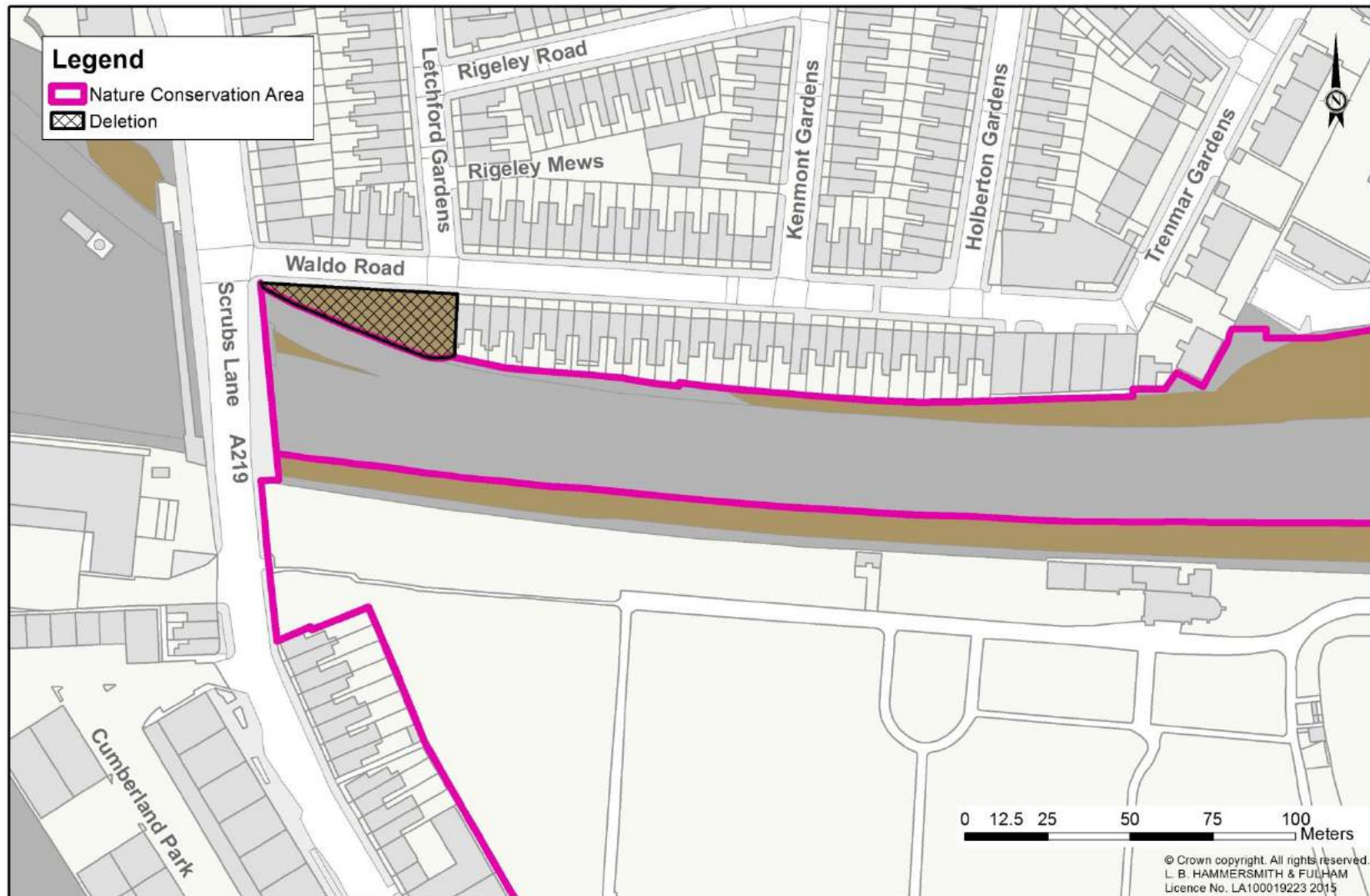

**Map AM23: Hammersmith Park Nature Conservation Area [B11.2]**



**Map AM24: Burlington Danes School Playing Fields and Courts [OS37]**





**Map AM25: Lillie Road Recreation Ground and Purcell Gardens [OS8]**



**Map AM26: Rowberry Mead [OS25]**

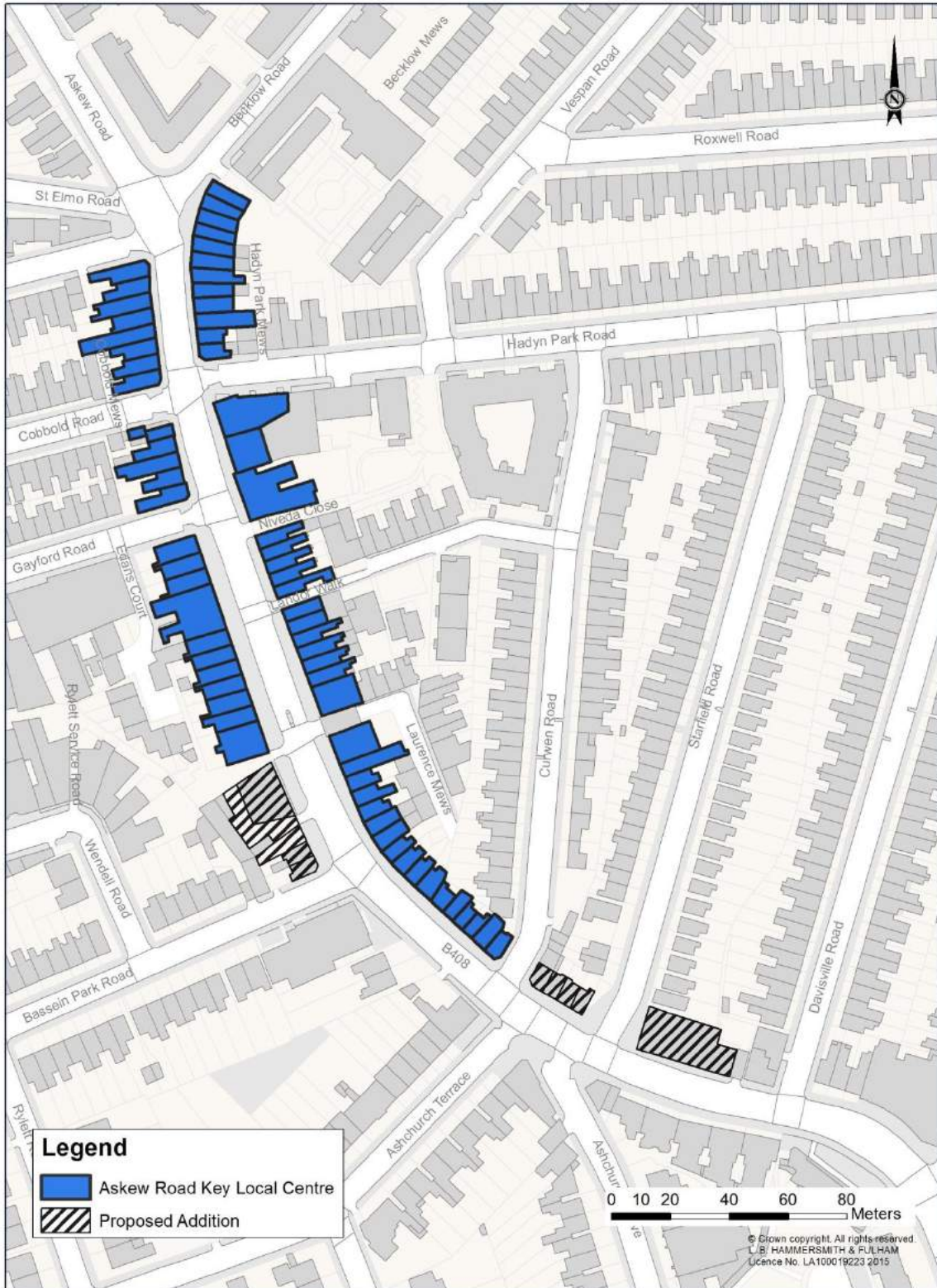

**Map AM27: Askew Road Key Local Centre**

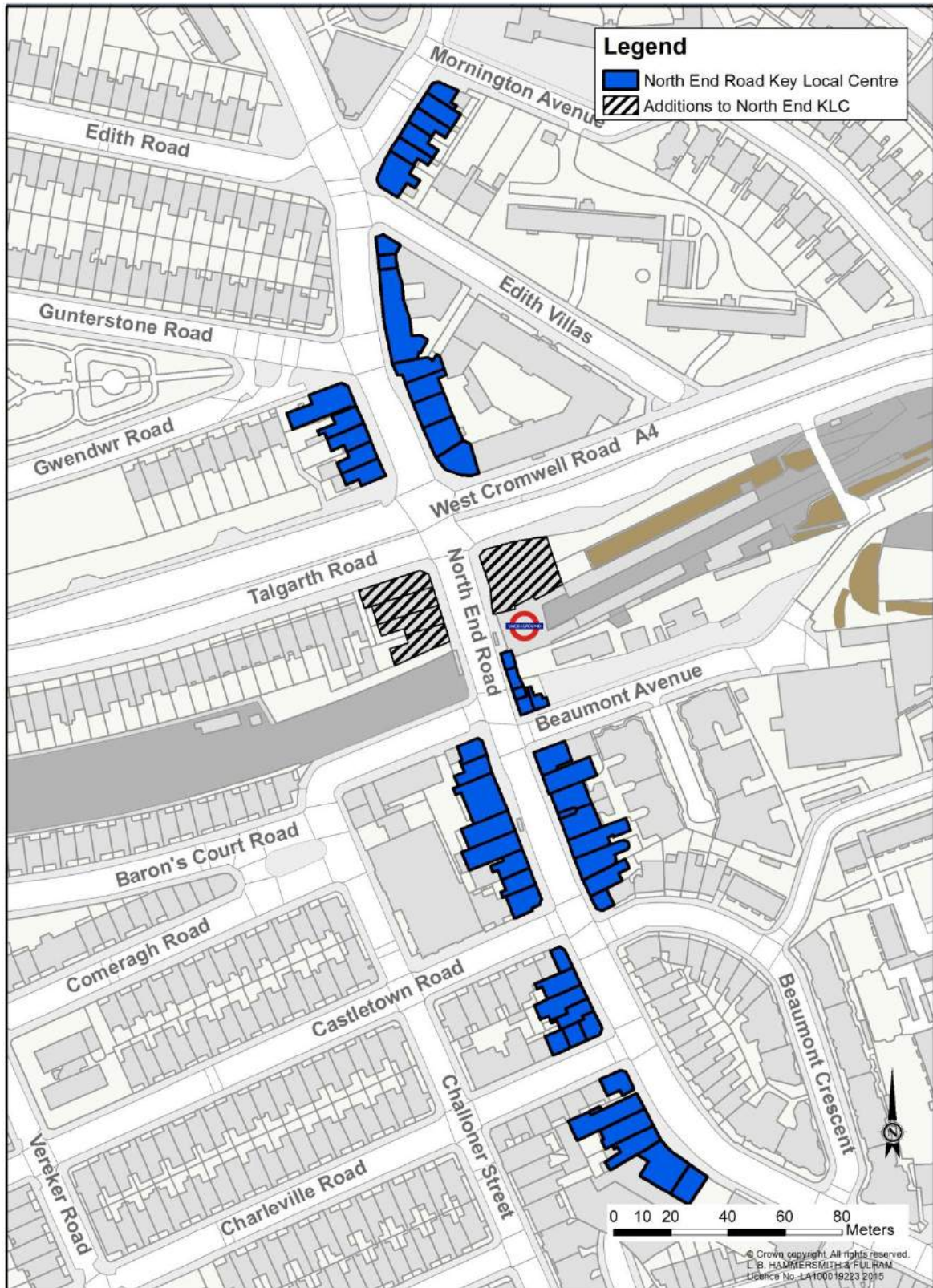

**Map AM28: North End Road Key Local Centre**

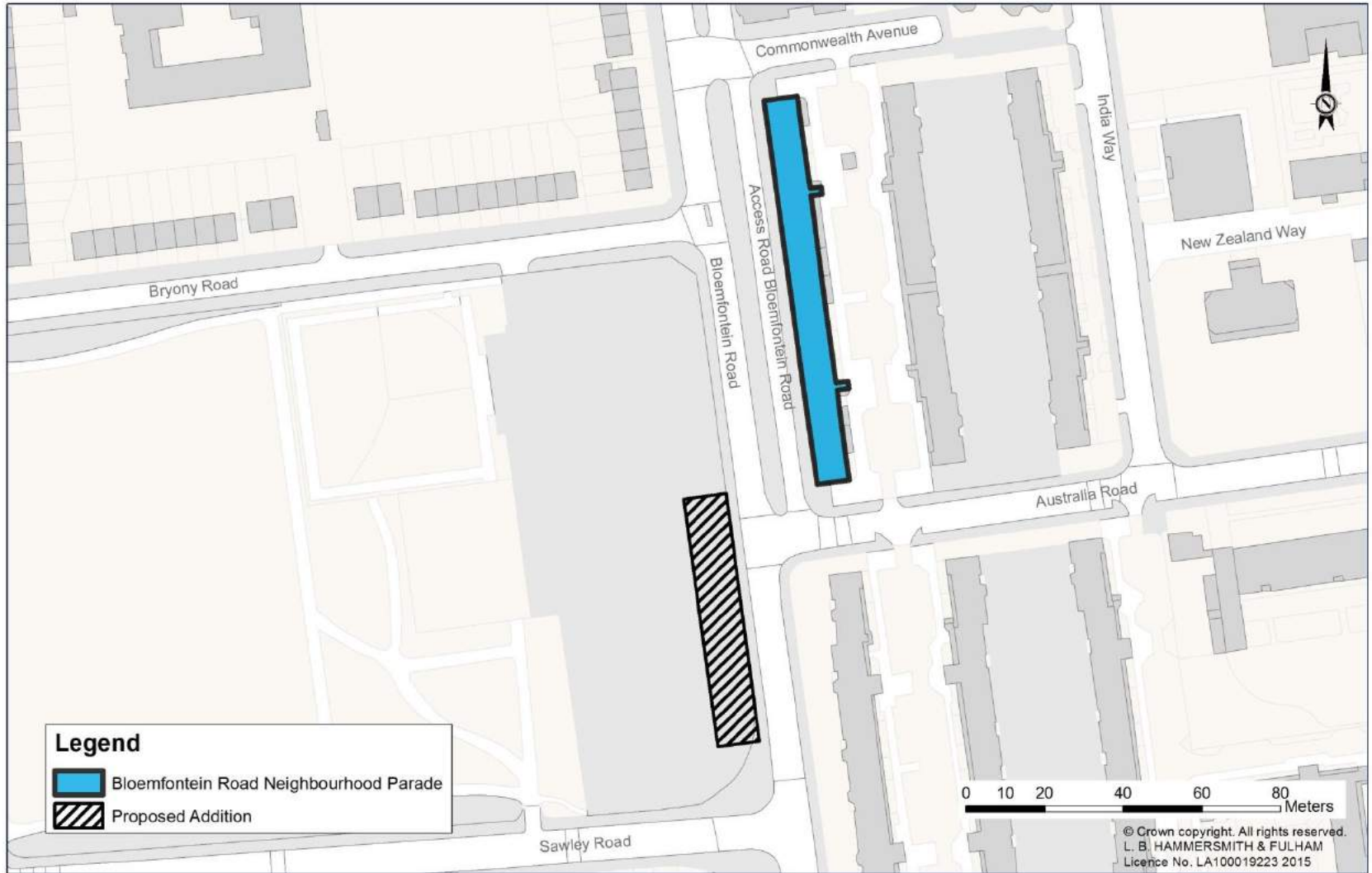

**Map AM29: Bloemfontein Road Neighbourhood Parade**



**Map AM30: Uxbridge Road Neighbourhood Parade**

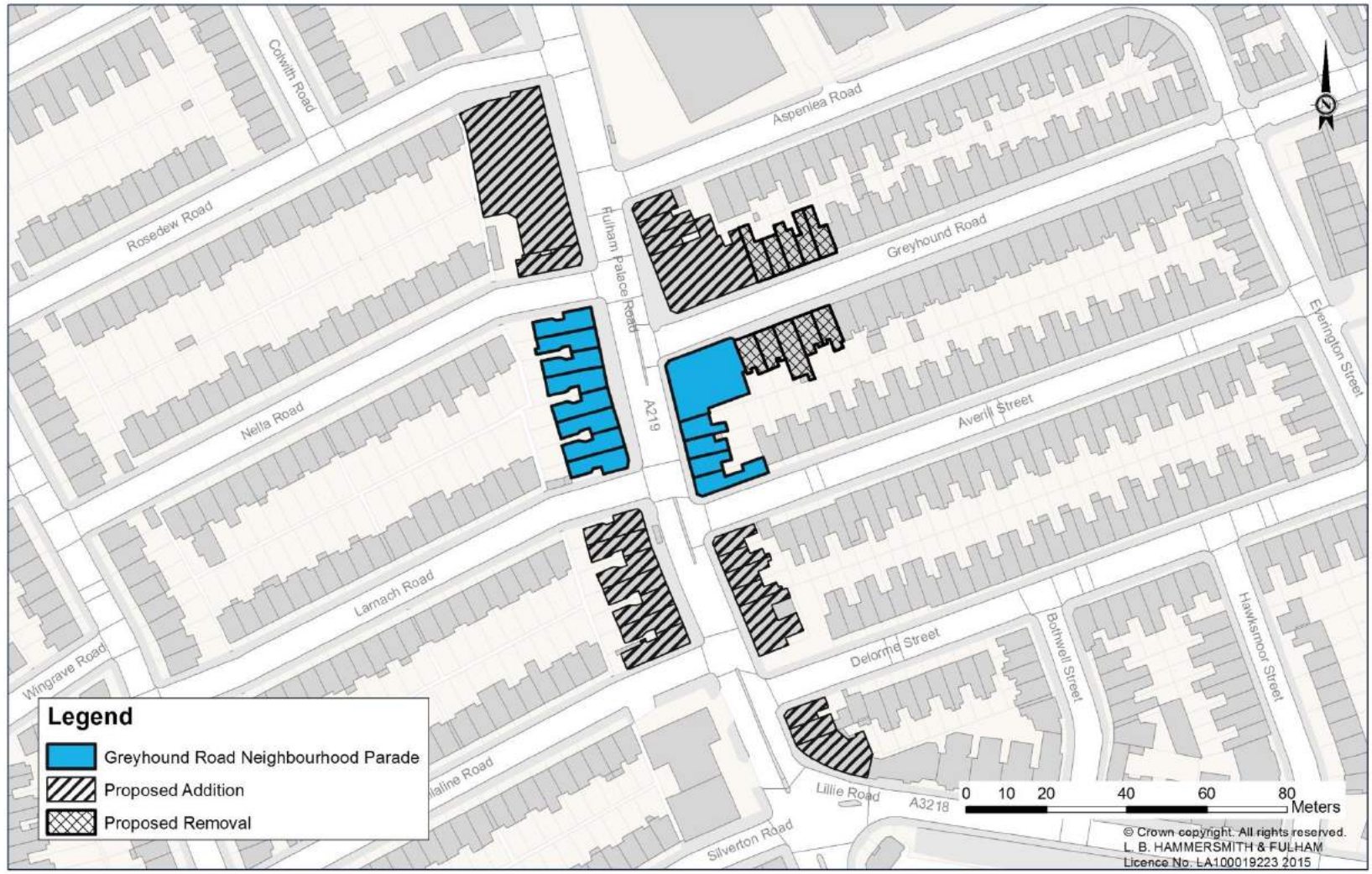

**Map AM31:  
Fulham Palace Road North (Greyhound Road) Neighbourhood Parade**

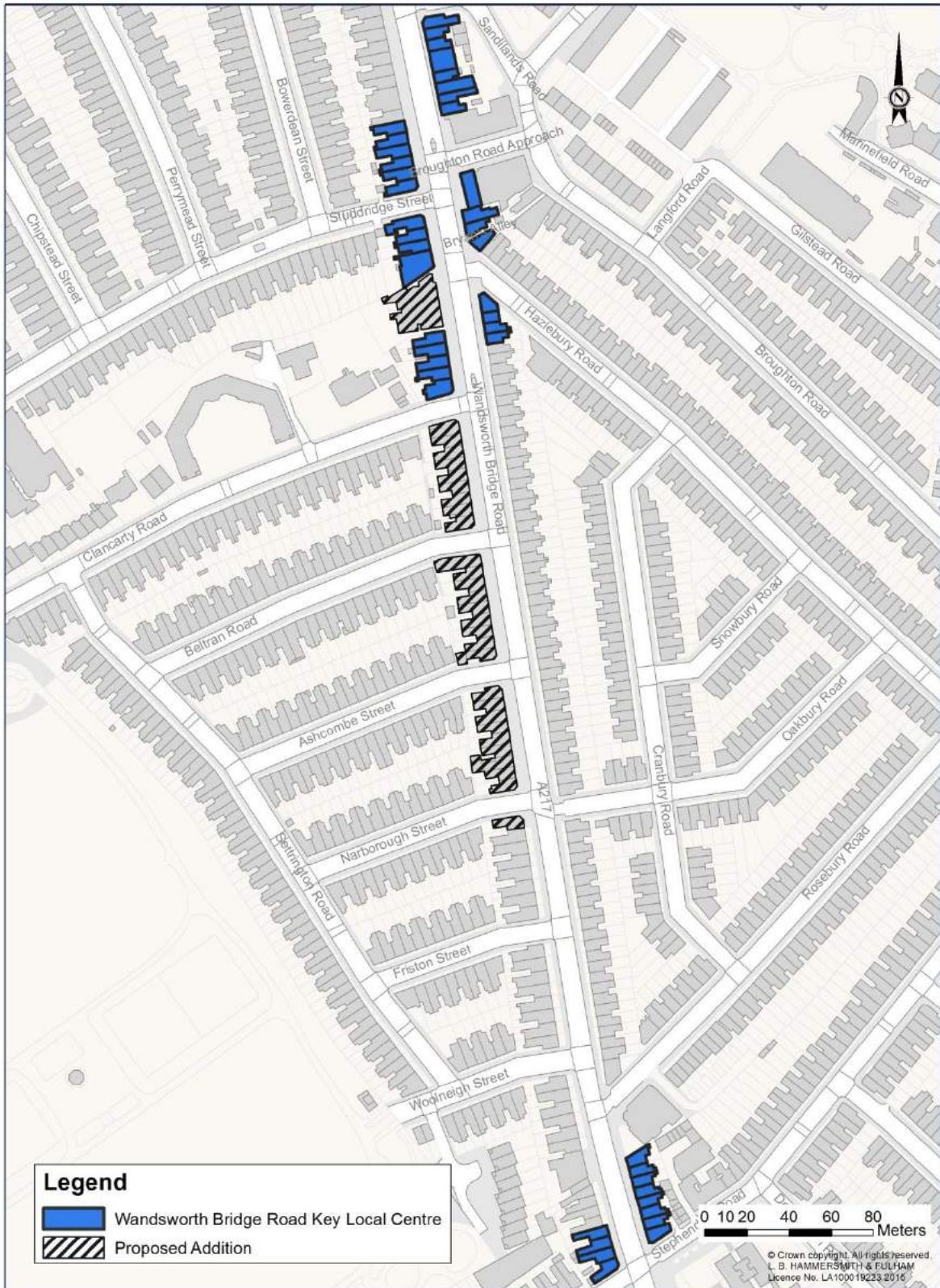

**Map AM32: Wandsworth Bridge Road Key Local Centre**



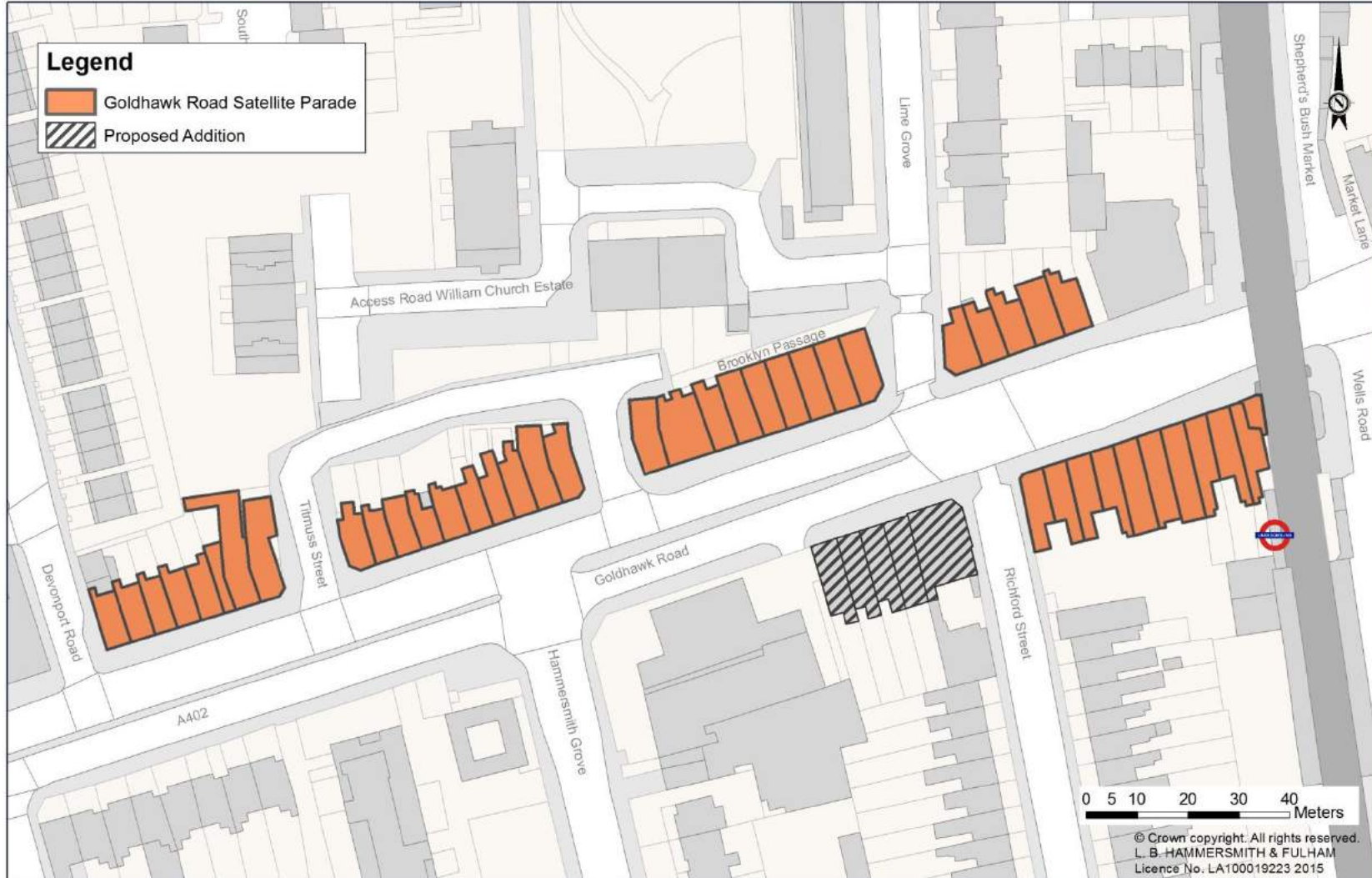

**Map AM33: Goldhawk Road Satellite Parade**

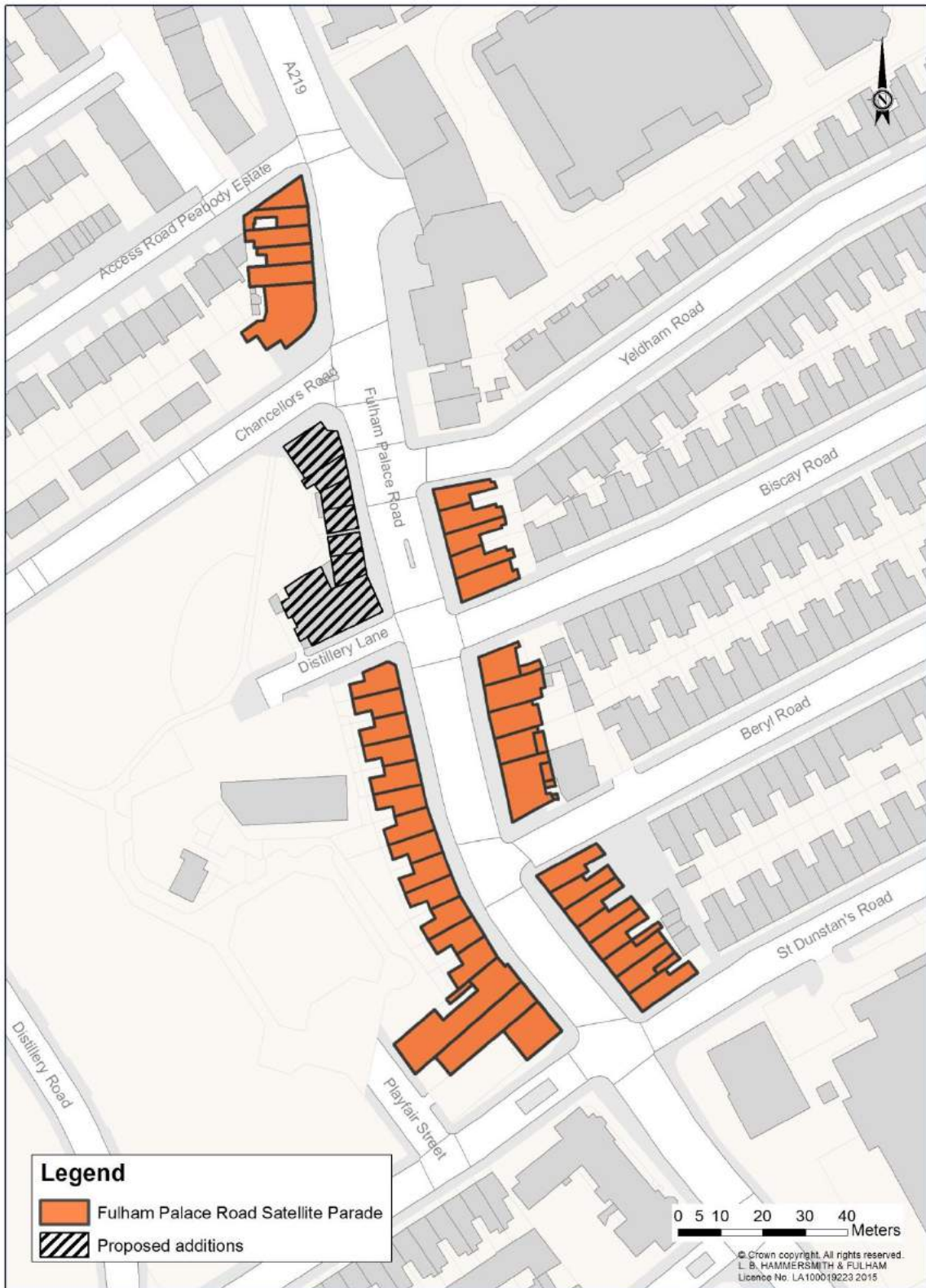

**Map AM34: Fulham Palace Road Satellite Parade**

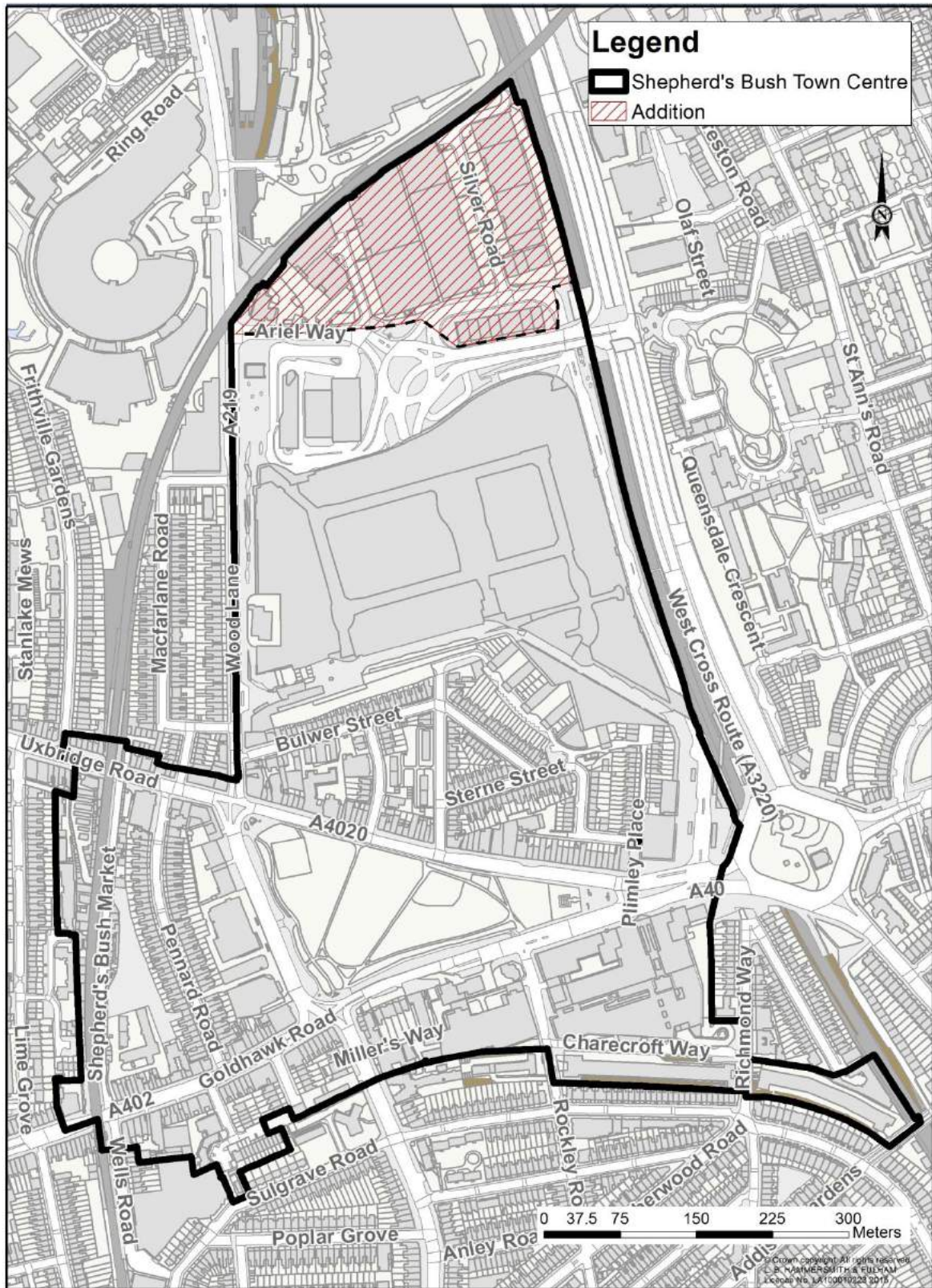

**Map AM35: Shepherd's Bush Town Centre**

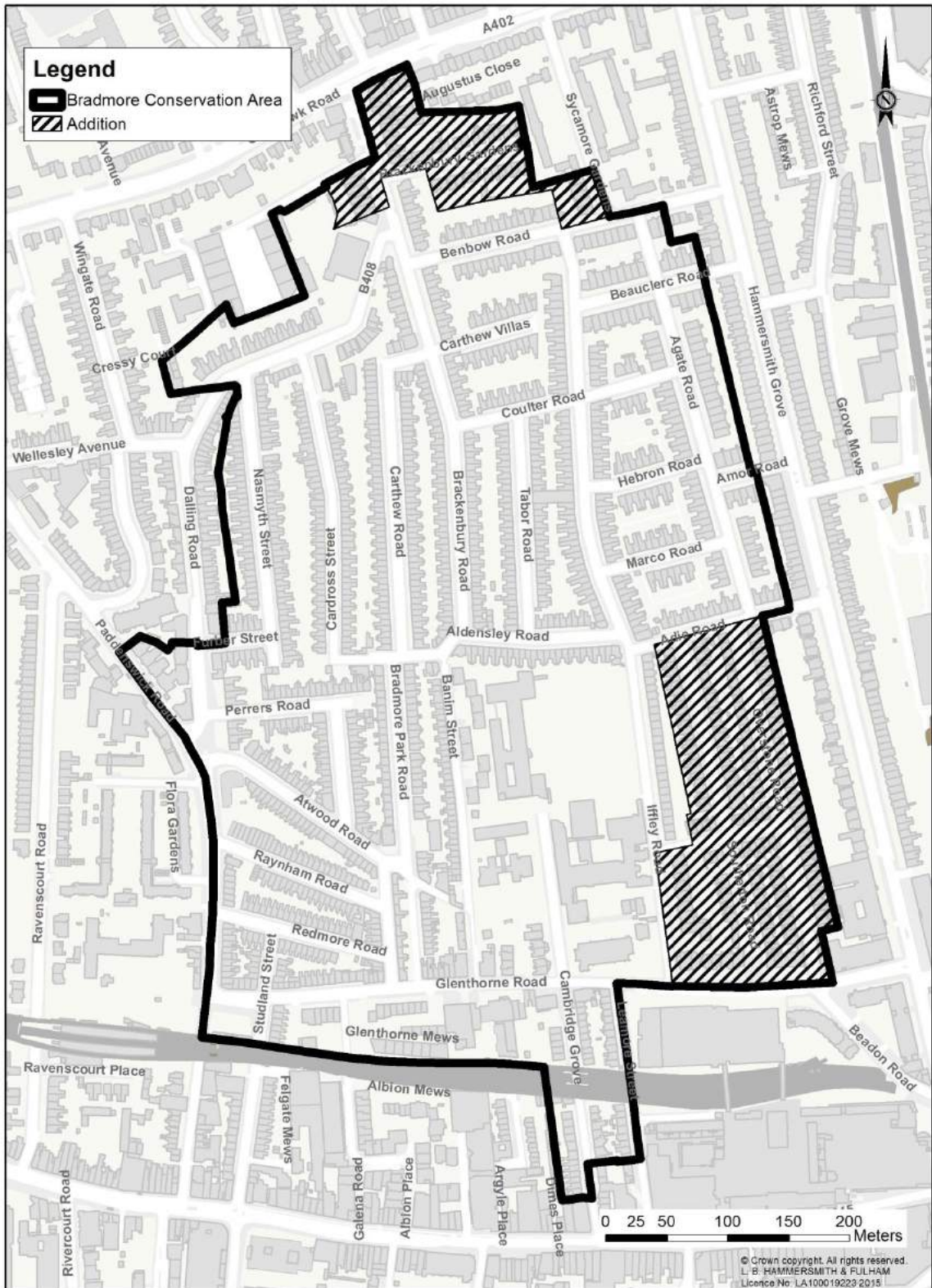

**Map AM36: Bradmore Conservation Area**

